

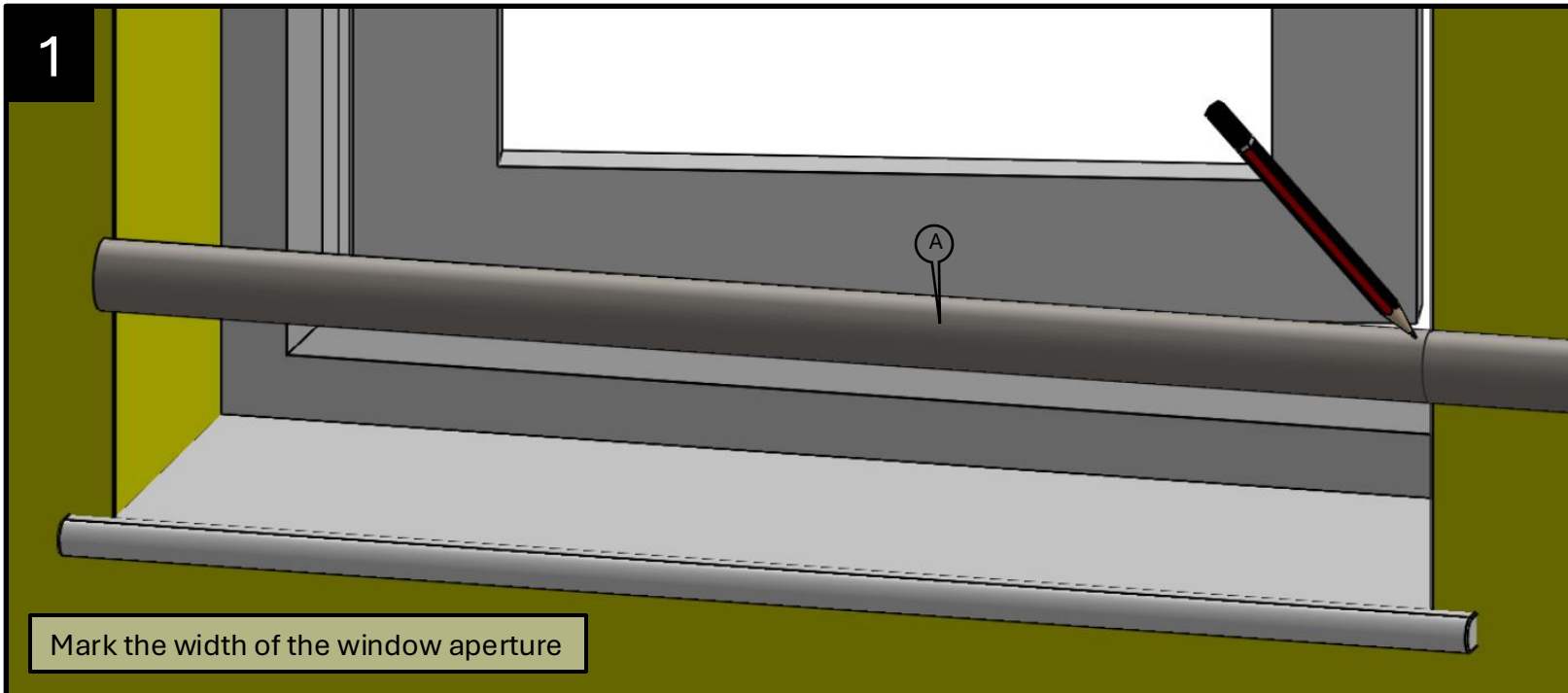

Bullfix Window Bar Installation Instructions

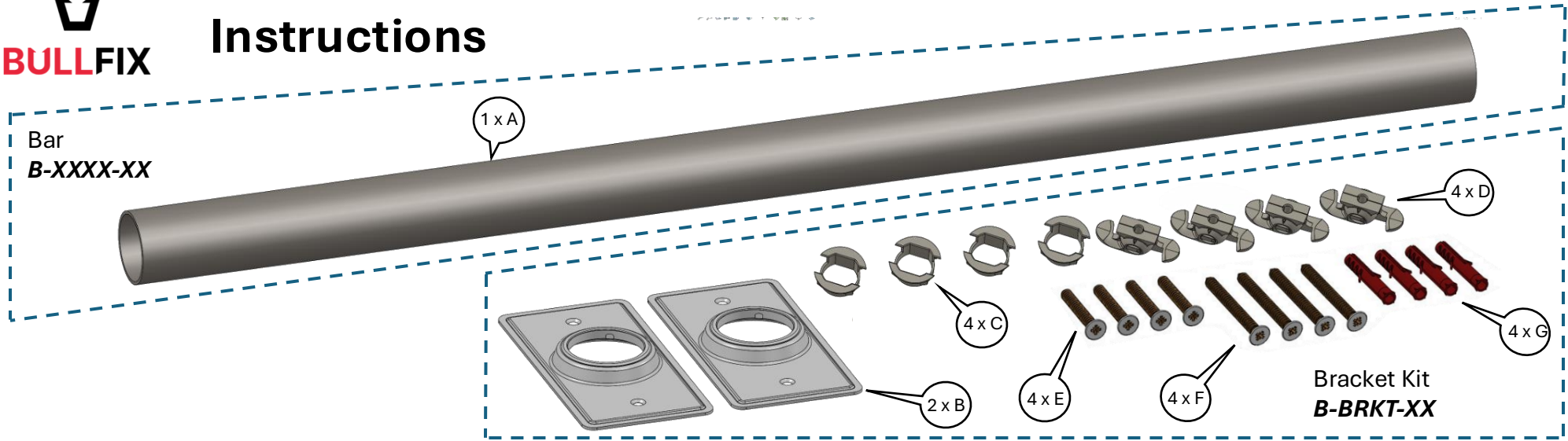

2

Cut the bar 5mm shorter

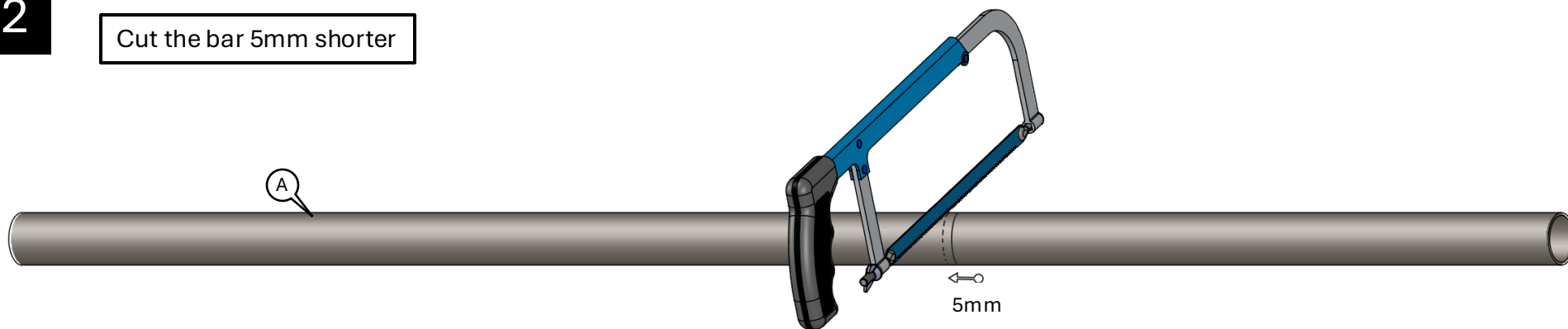

3

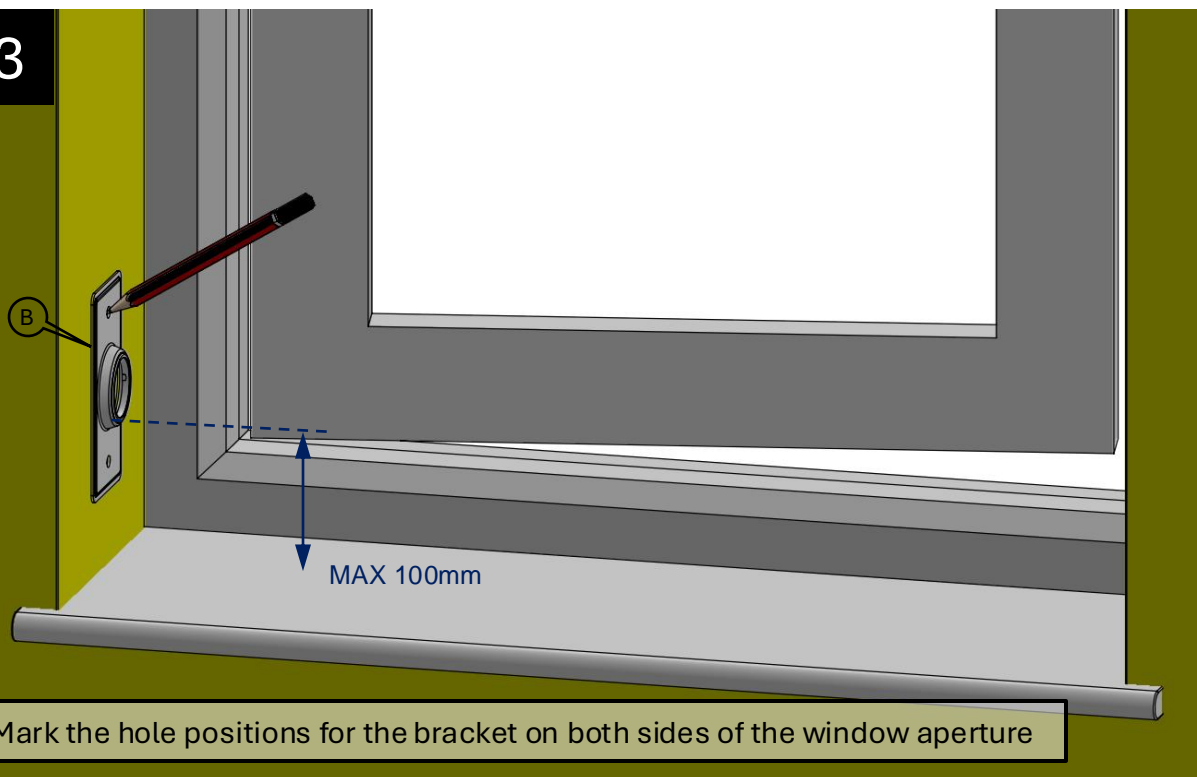

3b

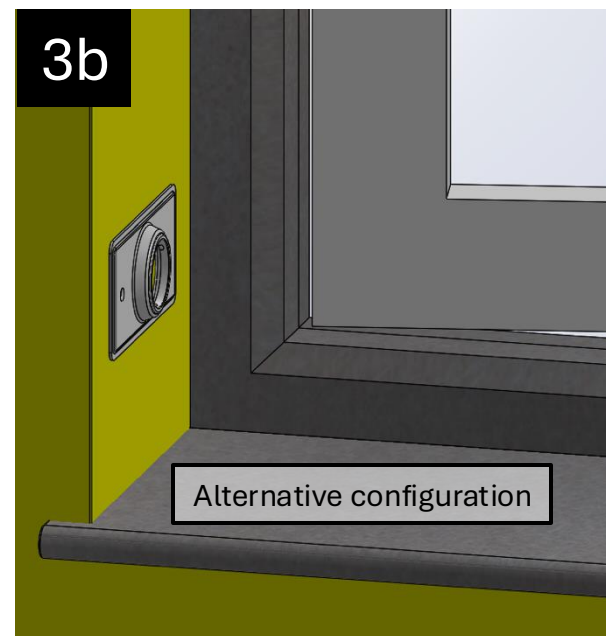

MULTIPLE FIXING METHODS

Plasterboard Cavity

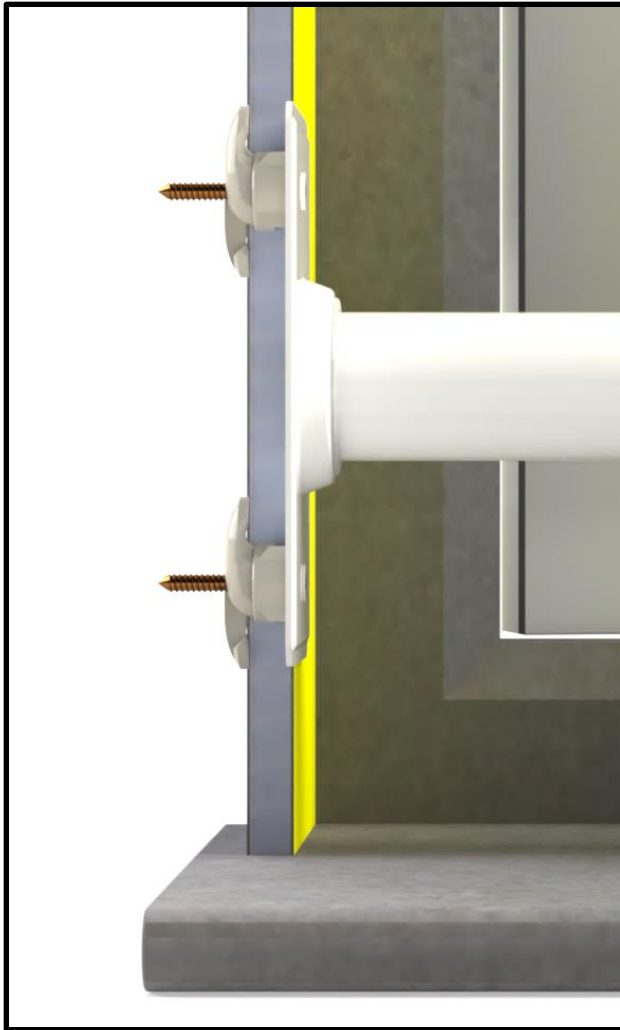

Wood Stud



Masonry

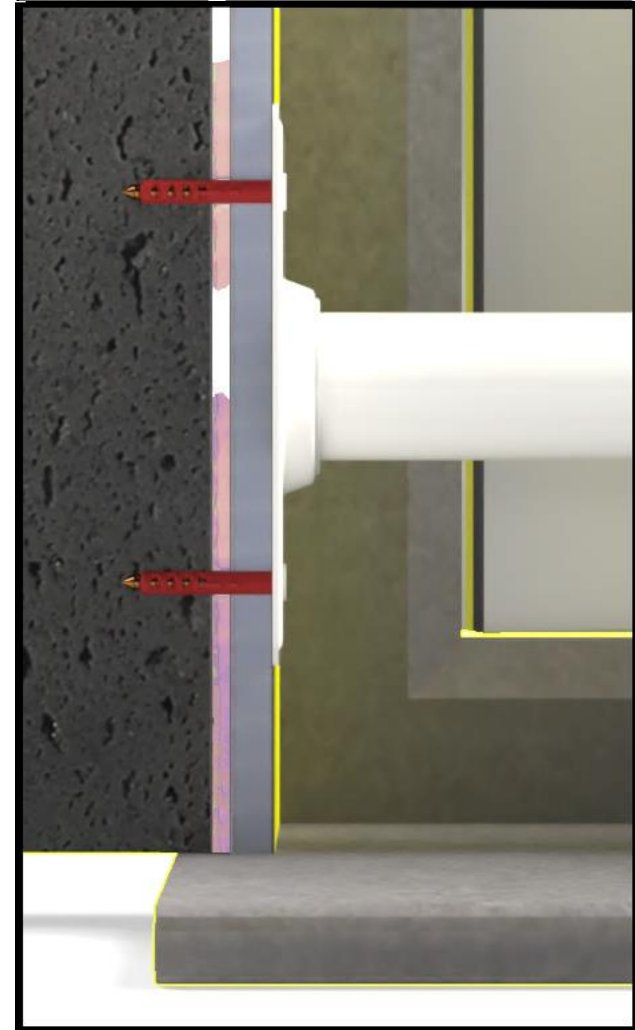

For Mounting To Plasterboard

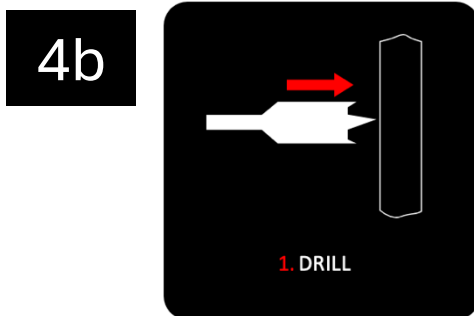
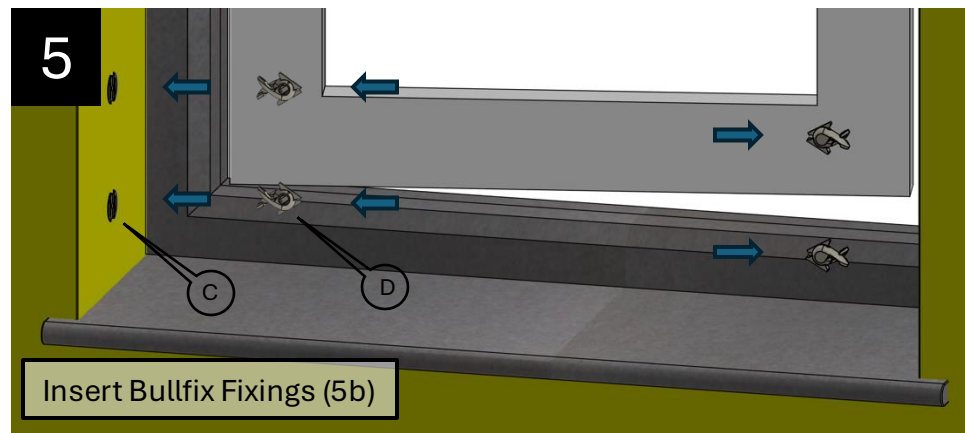
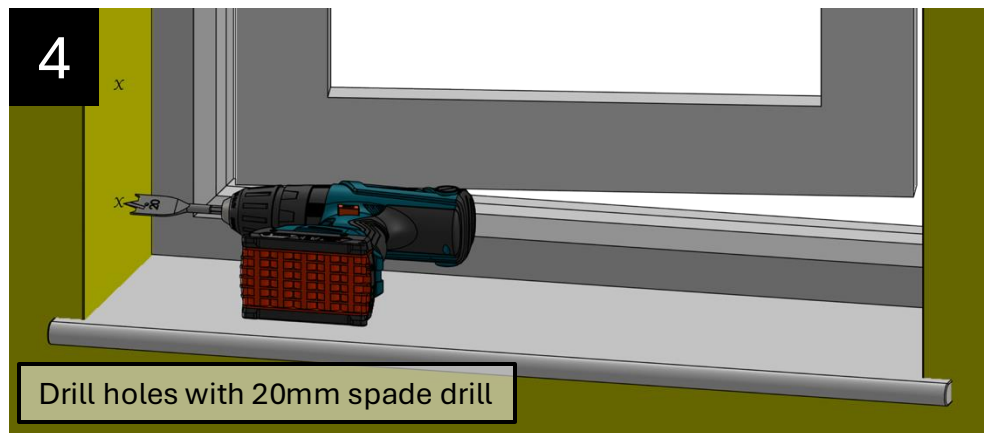

5b

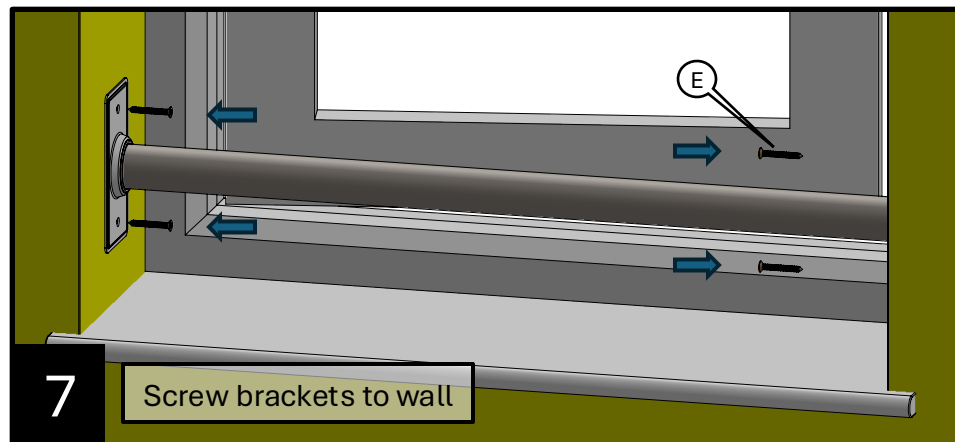
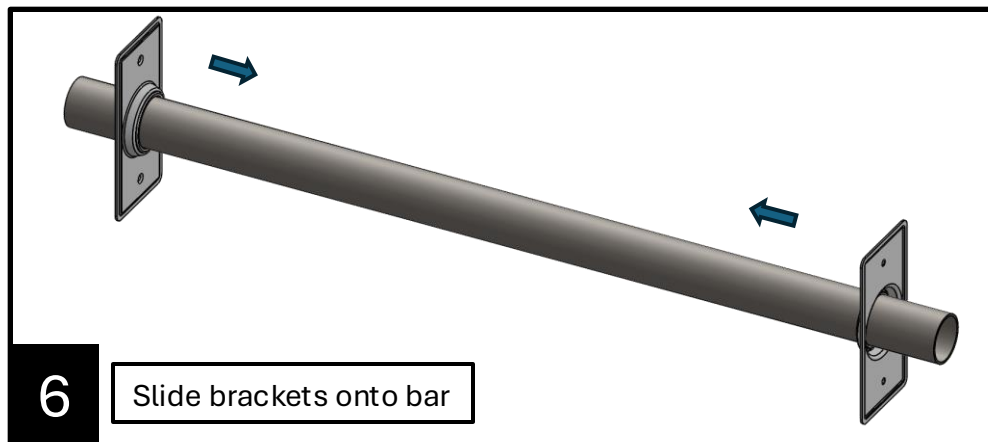
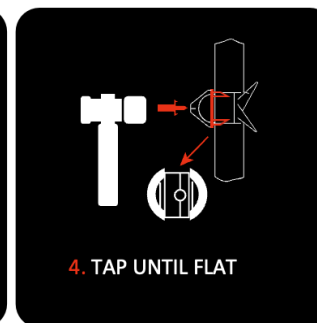
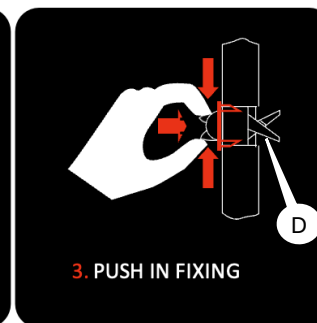
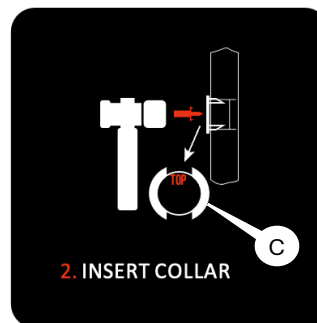

For Mounting To Wood Studs

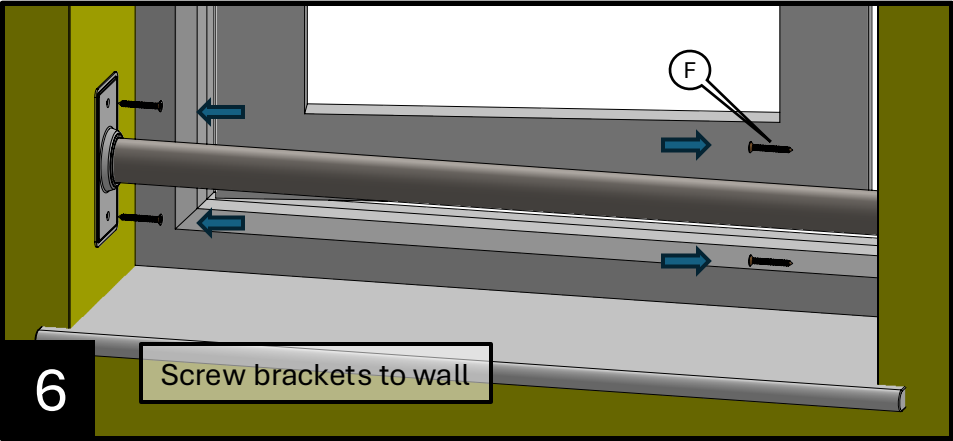
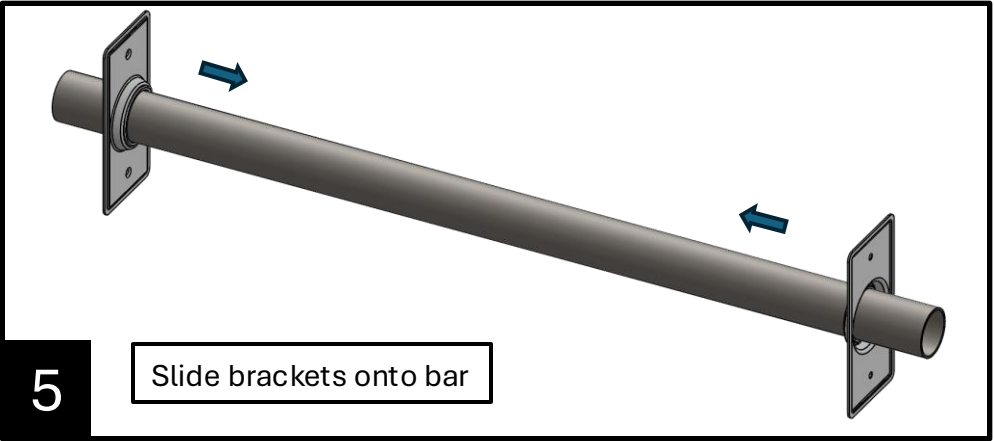
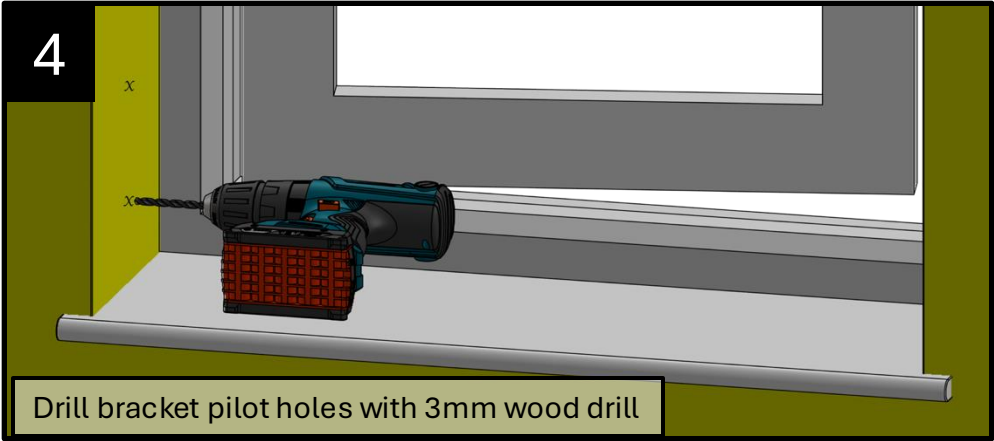

For Mounting To Masonry

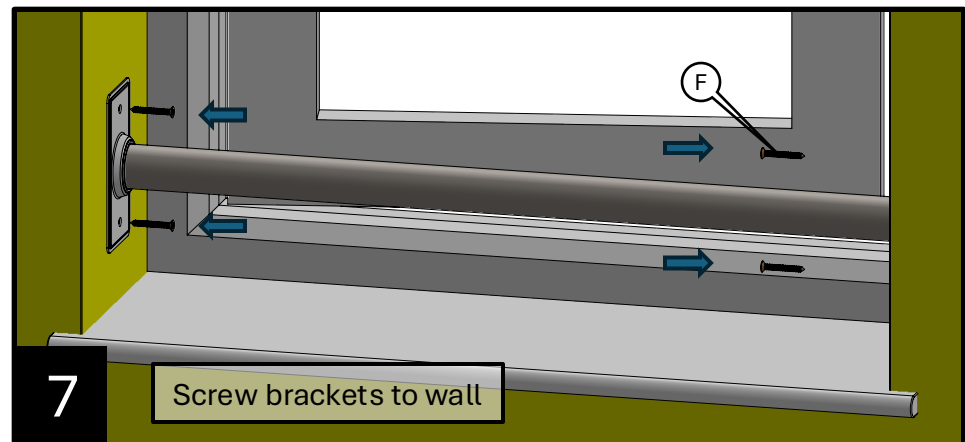
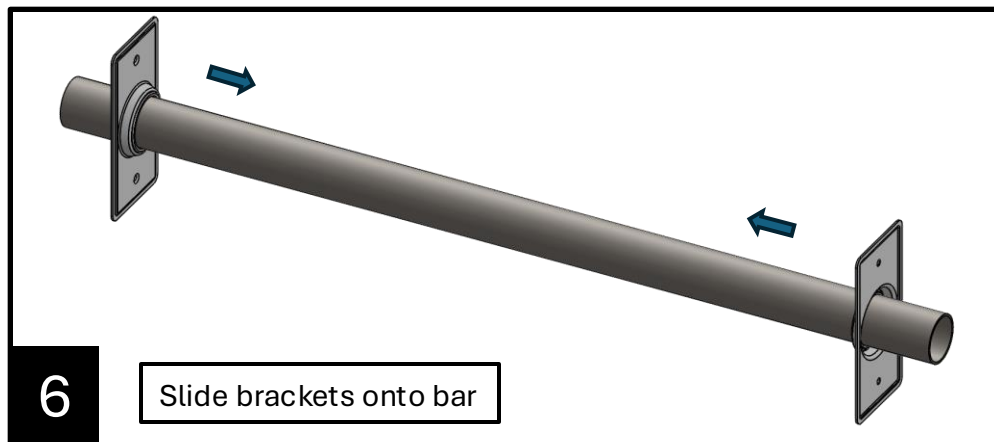
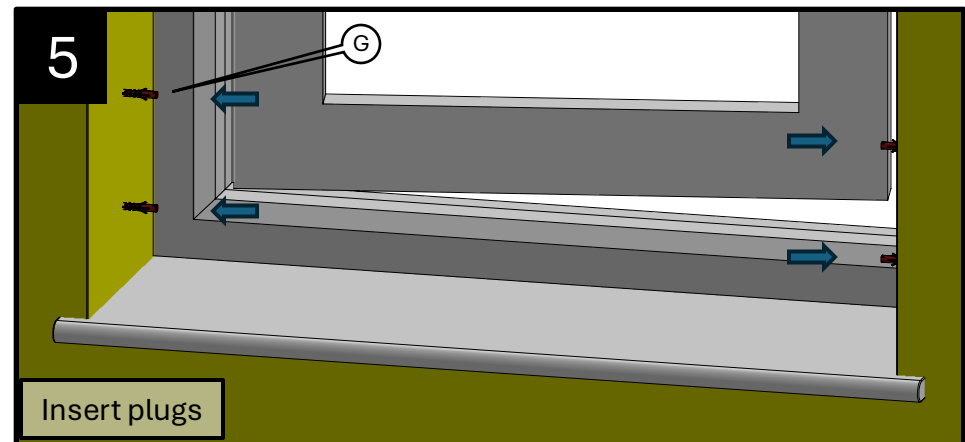
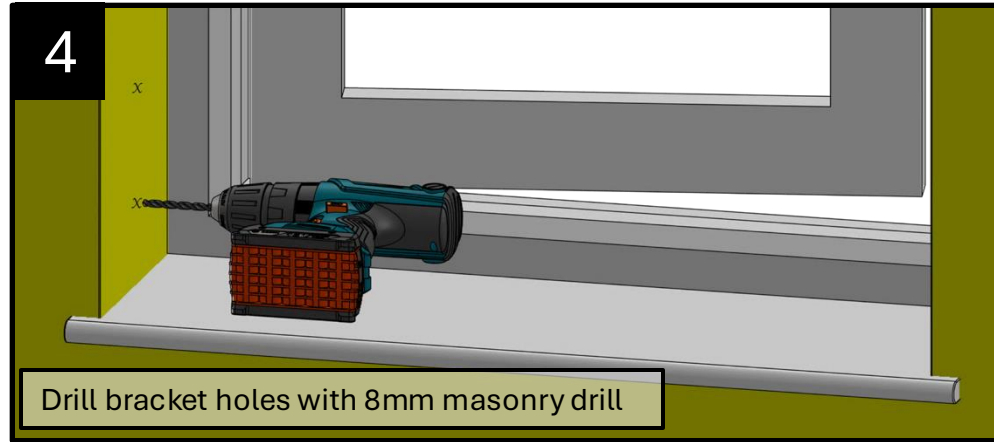



For more information on how to use Bullfix Plasterboard fixings scan this QR code

